

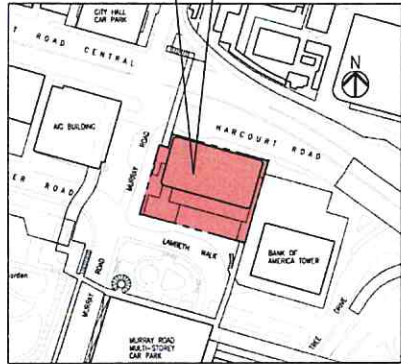

註冊樓宇編號 Memorial No.:
24020500470015 A3C



SITE PLAN

NO.10 HARCOURT ROAD, CENTRAL, HONG KONG
香港夏愨道 10 號

--- LOT BOUNDARY



DEDICATED AREA WITH EXEMPTED G.F.A. & BONUS PLOT RATIO = 24.193 SQ.M



DEDICATED AREA WITH EXEMPTED G.F.A. BUT WITHOUT BONUS PLOT RATIO = 75.639 SQ.M



DEDICATED AREA WITHOUT BONUS PLOT RATIO = 4.285 SQ.M

TOTAL DEDICATED AREA = 104.117 SQ.M.

MURRAY ROAD 紅棉路

HARCOURT ROAD 夏愨道

LAMBETH WALK 琳寶徑

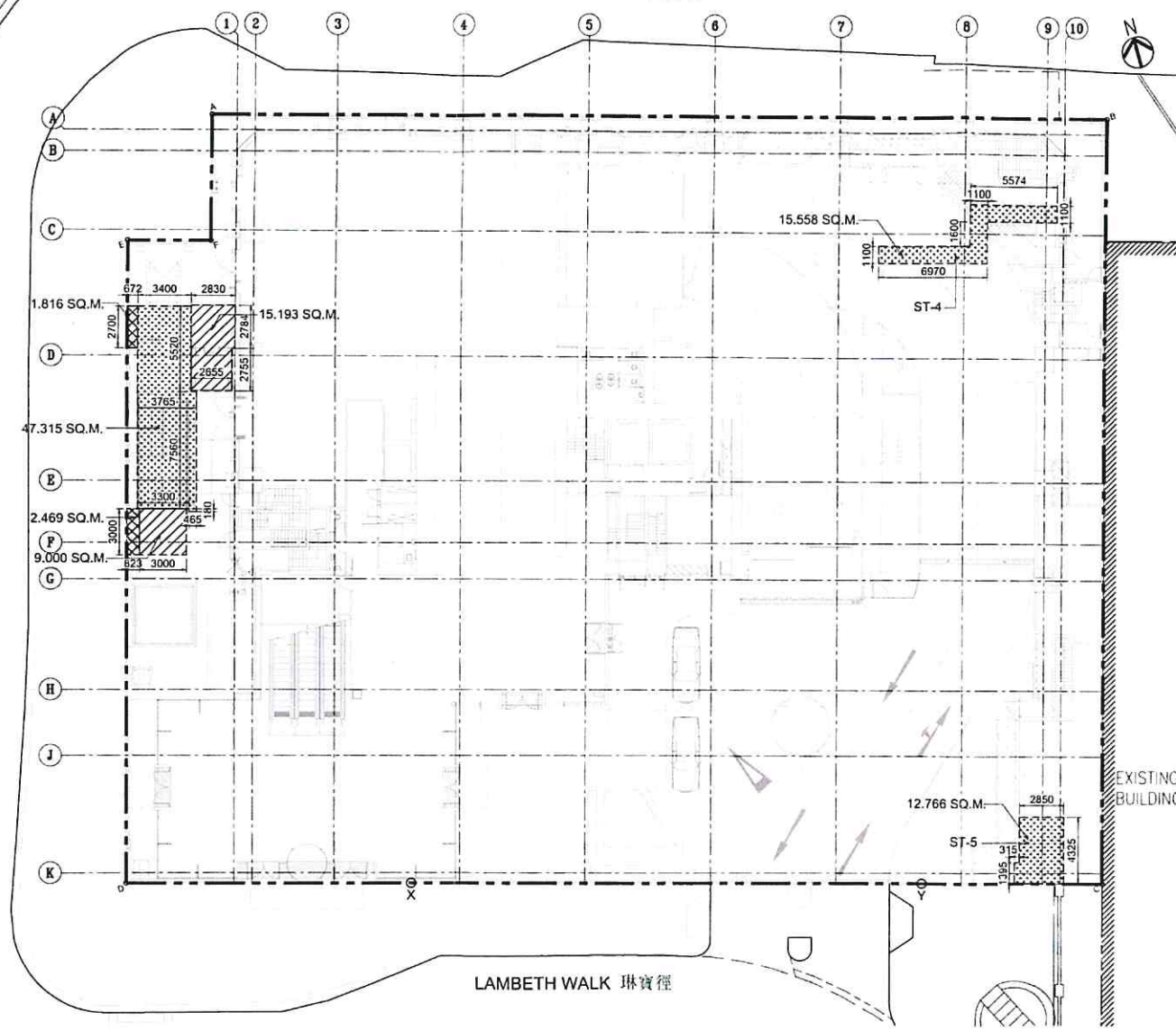

GROUND FLOOR PLAN

DD REFERENCE	DATE
F.S.D REFERENCE	DATE
W.K.D REFERENCE	DATE
DWG FILE NAME	DATE
H:\Proj\VCIS\Submission Plans (DTP)\Dedication Submission\2204DP_DTP(A).dwg	
NOTES	1/1

NO.	REVISIONS	DATE	BY
A	PROT. CHECKED	04/2023	HK



DLN Architects Limited
DLN Architects Limited is a member of the DLN Group of Companies. DLN Architects Limited is a member of the DLN Group of Companies. DLN Architects Limited is a member of the DLN Group of Companies.

PROJECT: PROPOSED OFFICE REDEVELOPMENT AT NO. 10 HARCOURT ROAD I.L. No. 8286 CENTRAL, HONG KONG.

DRAWING TITLE: DEDICATION PLAN - GROUND FLOOR

SCALE:	DATE:
1 : 150 (A1)	07-2022
1 : 300 (A3)	
DRAWN BY: H.M.A.	CHECKED BY:
HO	C. FONG
JOB NO. 11543-H	DRAWING NO. 2204DP

SCHEDULE FOR DEDICATED & EXEMPTED AREA

FLOOR	(A) DEDICATED AREA WITH EXEMPTED G.F.A. & BONUS PLOT RATIO (S.M.)	(B) DEDICATED AREA WITH EXEMPTED G.F.A. BUT WITHOUT BONUS PLOT RATIO (S.M.)	(C) DEDICATED AREA WITH NON-ACCOUNTABLE G.F.A. AND WITHOUT BONUS PLOT RATIO(S.M.)	TOTAL (S.M.)
G/F	24.193	75.639	4.285	104.117
1/F	439.528	140.422	-	579.950
				684.067



註冊摘要編號 Memorial No.: 24020500470015 A3B

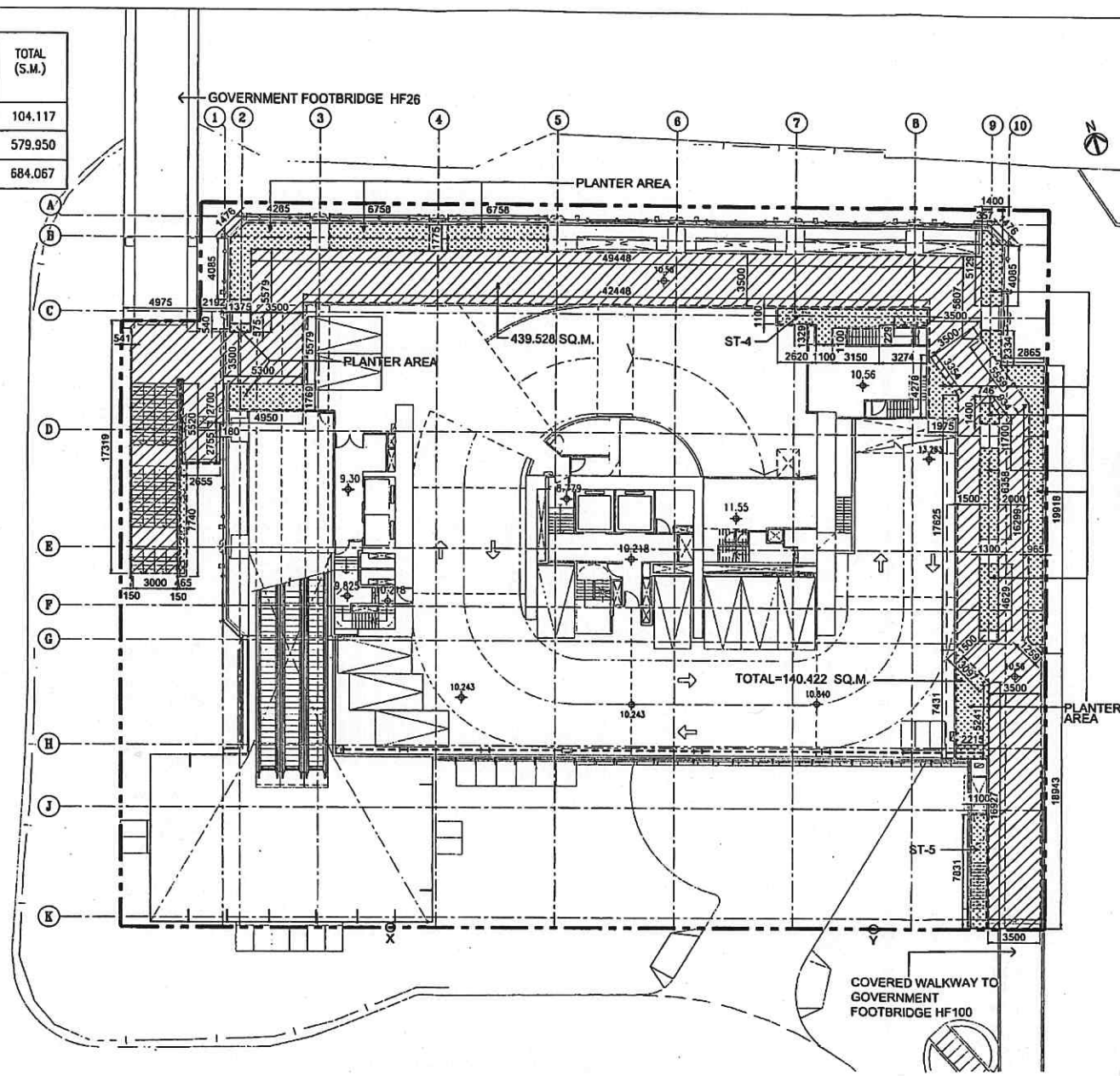

NO.10 HARCOURT ROAD, CENTRAL, HONG KONG
香港夏慤道 10 號

- LOT BOUNDARY
 - DEDICATED AREA WITH EXEMPTED G.F.A. & BONUS PLOT RATIO = 439.528 SQ.M
 - DEDICATED AREA WITH EXEMPTED G.F.A. BUT WITHOUT BOUNDS PLOT RATIO = 140.422SQ.M
- TOTAL DEDICATED AREA = 579.950 SQ.M.

FIRST FLOOR PLAN

S.D. REFERENCE		A3B03A	
F.A.D. REFERENCE		A3B03A	
W.H.O. REFERENCE		A3B03A	
CAD FILE NAME		N:\Project\220500_1\Floor Plan (300)\Building Submission\220500_1\F1(A3).dwg	
NOTES		3/8	
NO.	REVISIONS	DATE	BY
A	FIRST ISSUE	04/03/2013	ME
DLN			
DLN Architects Limited 11/F, 110, Canton Road, Hong Kong DLN Architects Limited 11/F, 110, Canton Road, Hong Kong 電話: 2525 2222 傳真: 2525 2222 www.dln.com.hk			
ALL DIMENSIONS UNLESS OTHERWISE SPECIFIED ARE IN METERS TO THE FACE UNLESS OTHERWISE SPECIFIED			
DO NOT SCALE FROM DRAWING. ALL DIMENSIONS SHALL BE AS SHOWN			
ALL RIGHTS RESERVED AND THE COPYRIGHT ARE THE PROPERTY OF THE ARCHITECT AND SHALL BE PROTECTED BY THE COPYRIGHT OF THE ARCHITECT			
PROJECT: PROPOSED OFFICE REDEVELOPMENT AT No. 10 HARCOURT ROAD I.L. No. 8286 CENTRAL, HONG KONG.			
DRAWING TITLE: DEDICATION PLAN - FIRST FLOOR			
SCALE	比例	DATE	日期
1 : 150(A1)		05-2013	
1 : 300(A3)			
DRAWN BY	繪圖人	CHECKED BY	校核人
MFL		C. FONG	
JOB NO. / 工程編號		DRAWING NO.	
N1543-H		2205DP	